

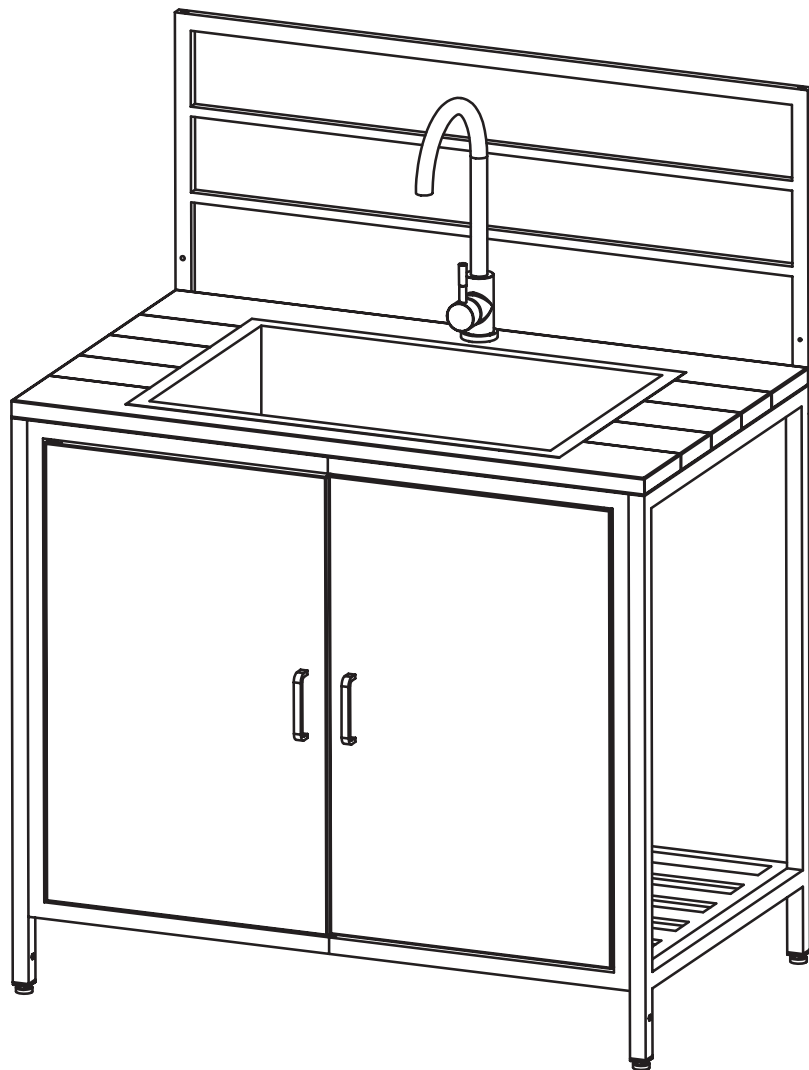

Sink w/Faucet Outdoor kitchen



FCC-A-10153

Assembly, maintenance and safety

RCC



The Flying Culinary Circus is the world's first traveling cooking group.

In 2005 Trond, Hans-Kristian, Mathias, and Tor went to New York.
A journey that ended up being an adventure of a lifetime.

With 65 countries and 300,000 hours of culinary experience in the Chef whites, we have developed, designed, and produced a wide range of grills and accessories that add something new and unique to the grill range in Scandinavia.

Each product is a testament to our commitment to high quality, functionality, and affordability.

We want to inspire the world through cooking with our vision:
"Share the Fun of Cooking!"

PARTS LIST

CODE	DESCRIPTION	QTY
1	BACK WALL	1
2	TABLE TOP	1
3	BOTTOM PANEL	1
4	RIGHT SIDE PANEL	1
5	LEFT SIDE PANEL	1
6	LEFT DOOR	1
7	RIGHT DOOR	1
8	DOOR FRAME	1
9	SINK	1
10	FAUCET	1
11	UPPER MAGNET HOLDER	1
12	UPPER MAGNET HOLDER	1
13	BACK CONNECTION	2
14	LEG CONNECTION	1
A	M6X25 SCREW	4
B	M6X40 SCREW	12
C	M6X40 SCREW	5
D	M4X12 SCREW	4
E	LOWER PIN	2
F	M6 PROTECTION WASHER	21
G	M4 PROTECTION WASHER	4

We recommend assembling the module on a flat surface.

Maximum load: 80 kg

Net weight: 17.3 kg

Maximum load table top: 50 kg

Maximum load bottom panel: 30 kg

Insert all screws first, do not tighten. Tighten all screws when module is fully assembled.

WARNING!

DO NOT USE ELECTRICAL TOOLS TO ASSEMBLE THE FURNITURE. TOOLS WITH EXCESSIVE FORCE MAY DAMAGE THE SURFACE COATING OF SCREWS, DAMAGE ENAMEL/PAINTED PARTS OF THE MODULES, AND LOOSEN PRE-FITTED NUTS.



TIPS! If the furniture appears crooked or bowed after fully assembled, loosen all the screws. Straighten each part and tighten screws again. The furniture should be placed and mounted on a level surface for the best possible result, but to take up any unevenness you can adjust the height of each leg individually.

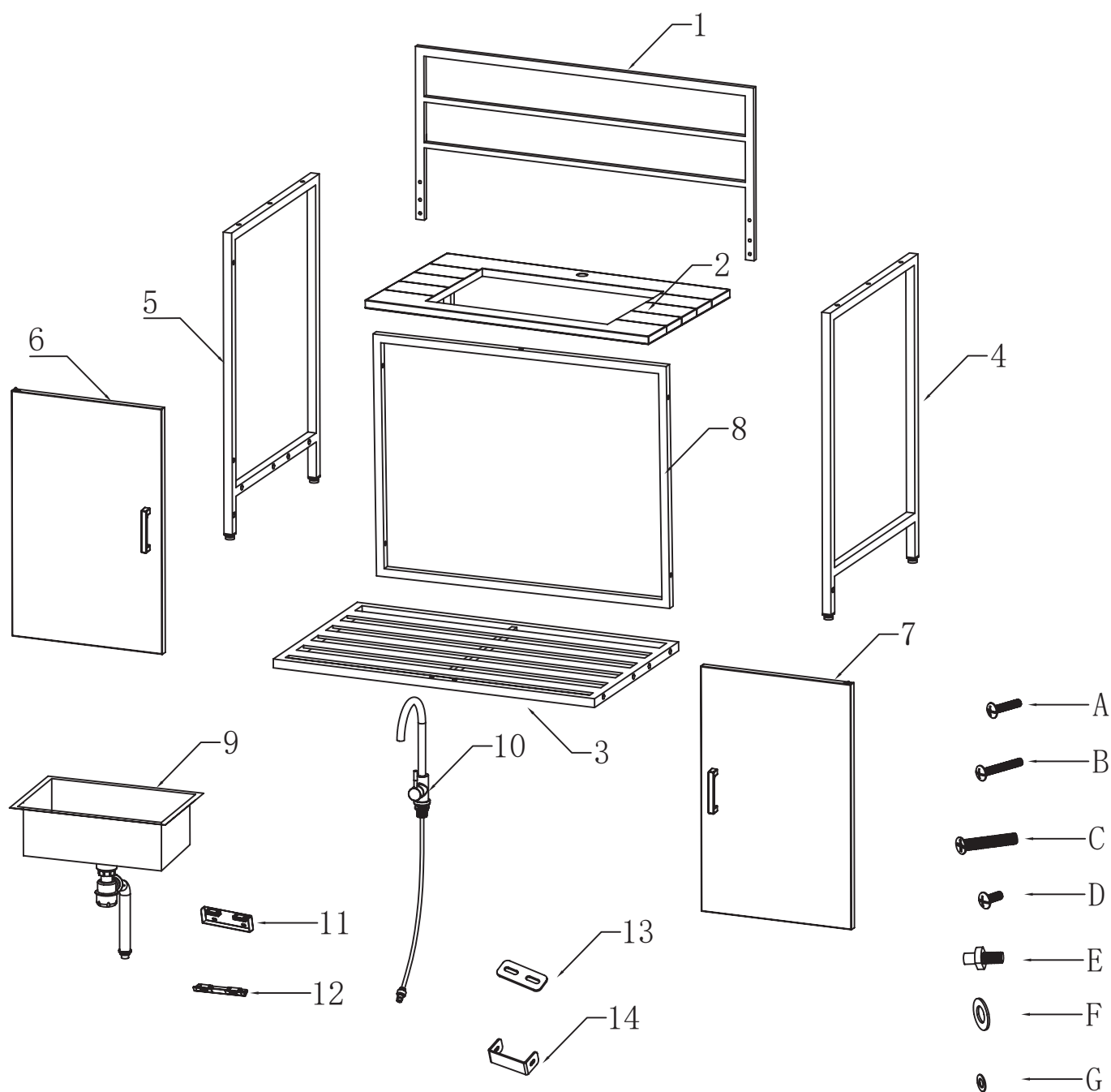

ASSEMBLY

1

Attach the left side panel (5) to the table top (2) with 3 pcs B screws and 3 pcs F protection washers.

PLACE A PIECE OF CARDBOARD ON THE FLOOR (E.G THE OUTER CARTON) TO PREVENT SCRATCHING THE UNIT AND PARTS DURING ASSEMBLY.

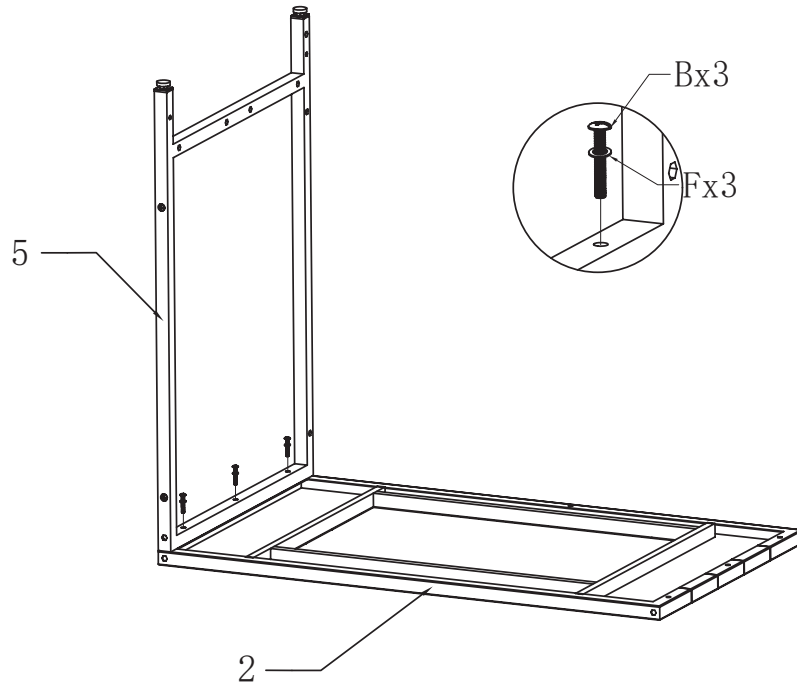

2

Attach the right side panel (4) to the table top (2) with 3 pcs B screws and 3 pcs F protection washers.

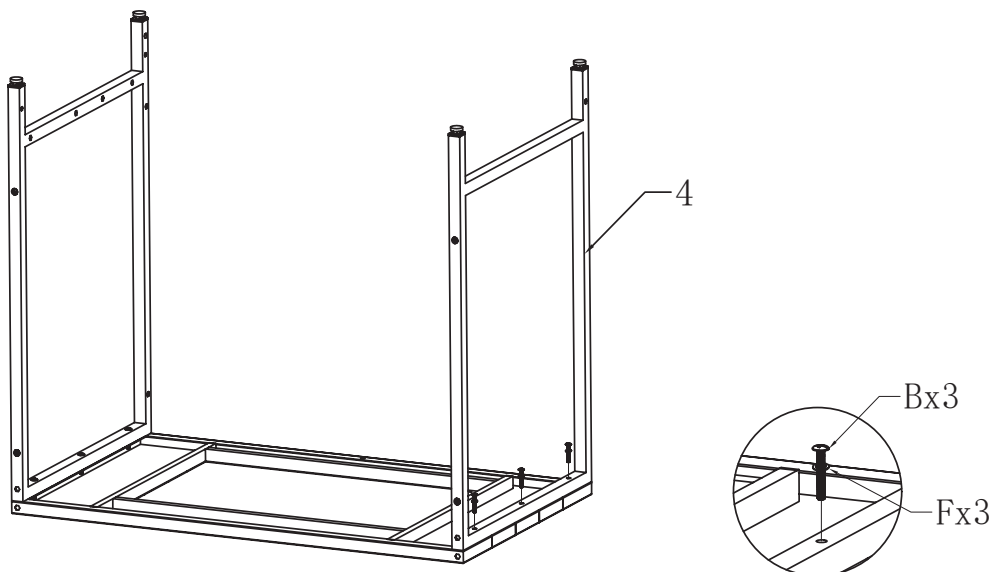

ASSEMBLY

3

Attach the bottom panel (3) to the side panels with 6 pcs B screws and 6 pcs F screw washers.

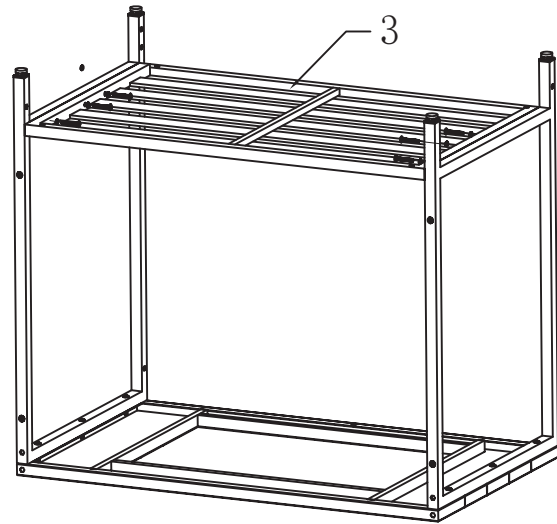
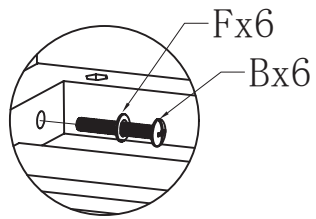

4

Attach the lower magnet holder (12) to the bottom panel with 2 pcs D screws and 2 pcs H protection washers.

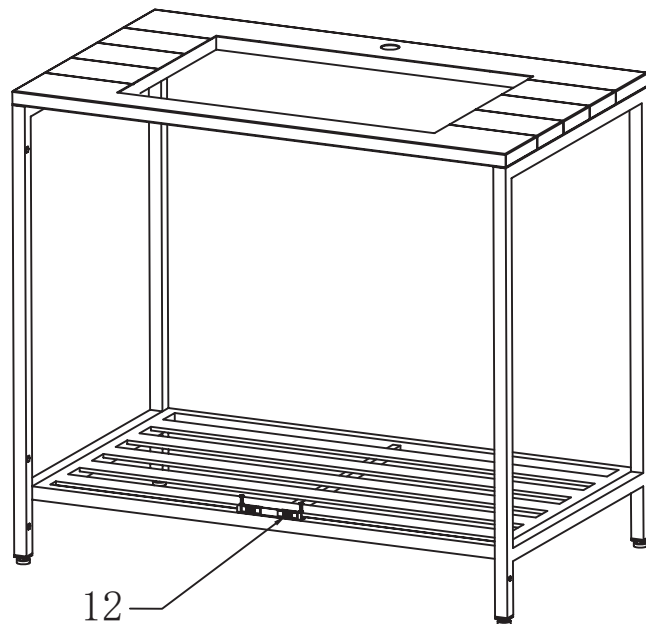
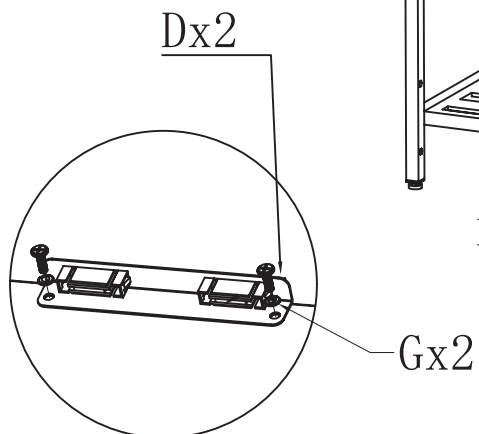

ASSEMBLY

5

Attach the upper magnet holder (11) to the door frame (8) with 2 pcs D screws and 2 pcs G protection washers.

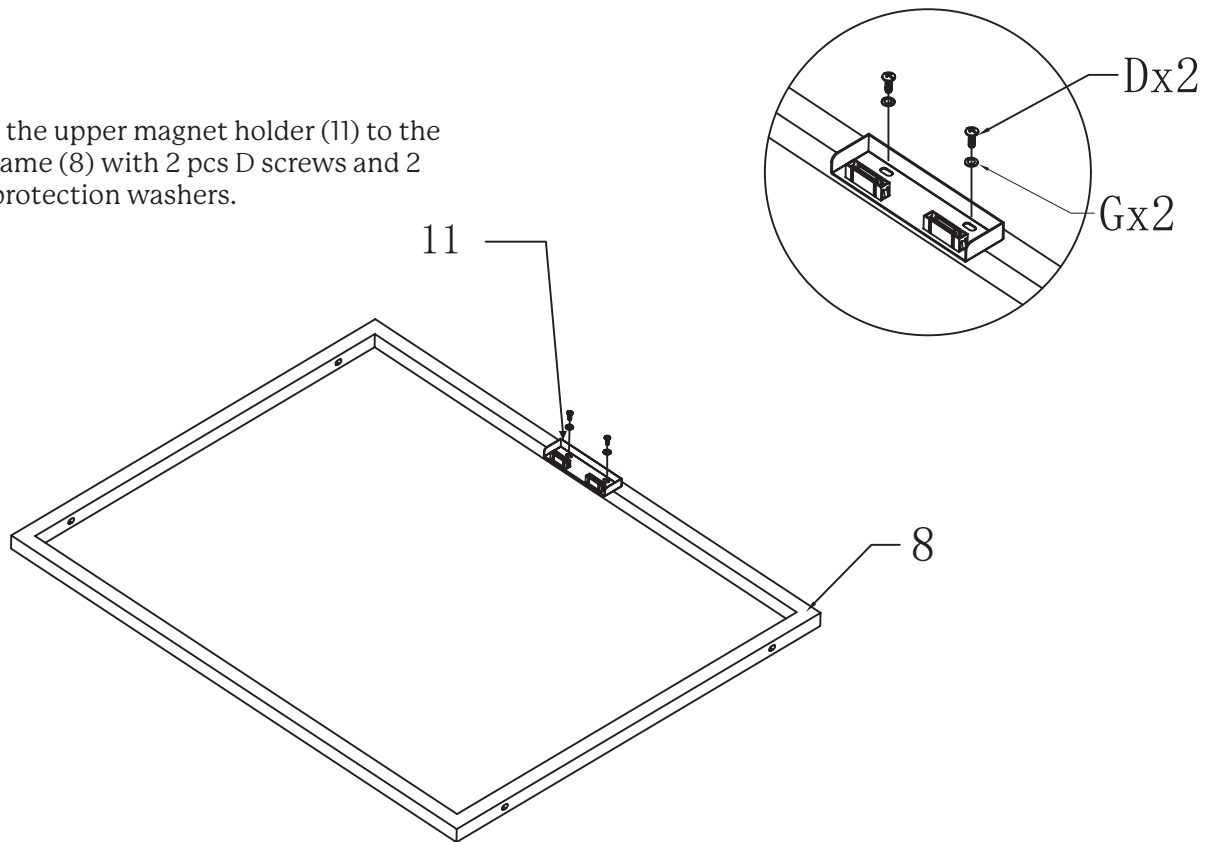

6

Attach the door frame to the assembly with 5 pcs C screws and 5 pcs F protection washers.

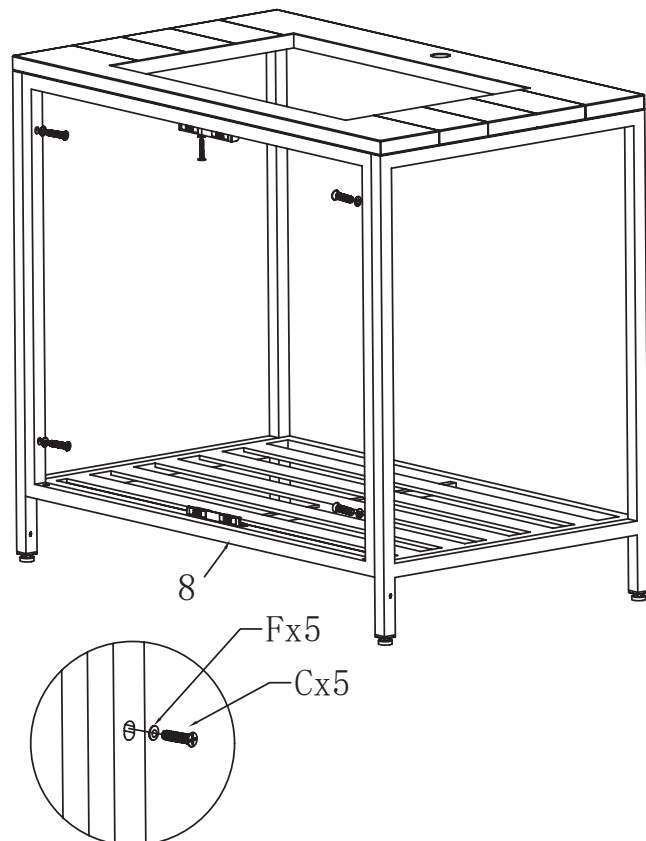

ASSEMBLY

7

Disassemble the pre-installed door handles on inside of doors (6 and 7), and install them on out side of doors with the screws provided. Screw one door pin (E) into each door.

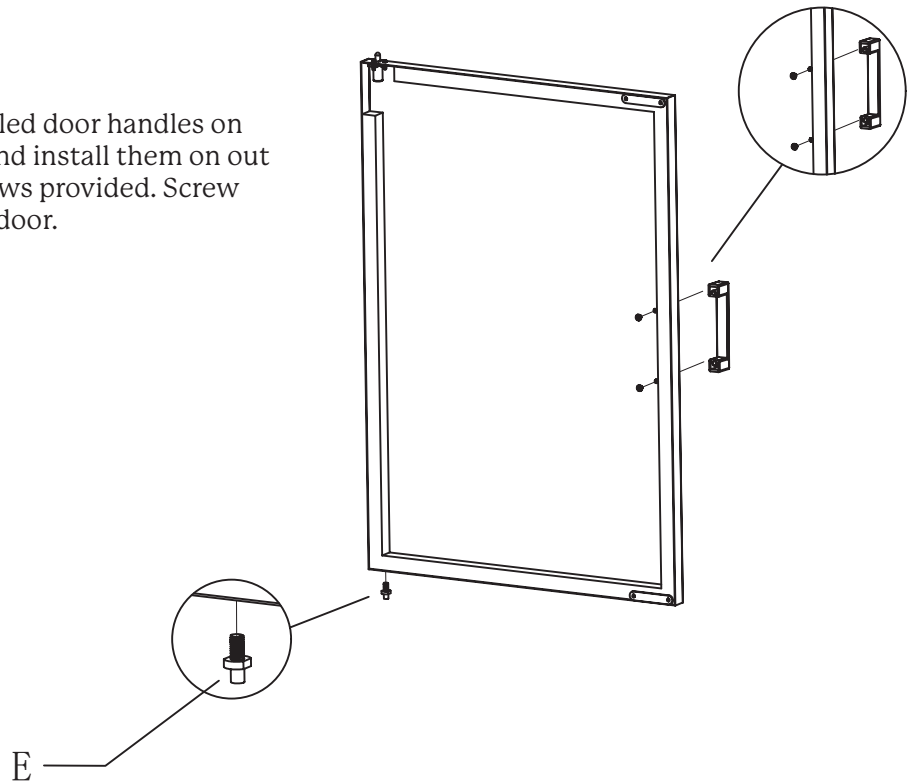

8

1.Insert the lower door pin into the hole of the door frame.
2.Press the upper pin and push the door into the frame, then release the upper pin and let it insert into the hole of the door frame.Repeat the same procedure for the other door assembly.

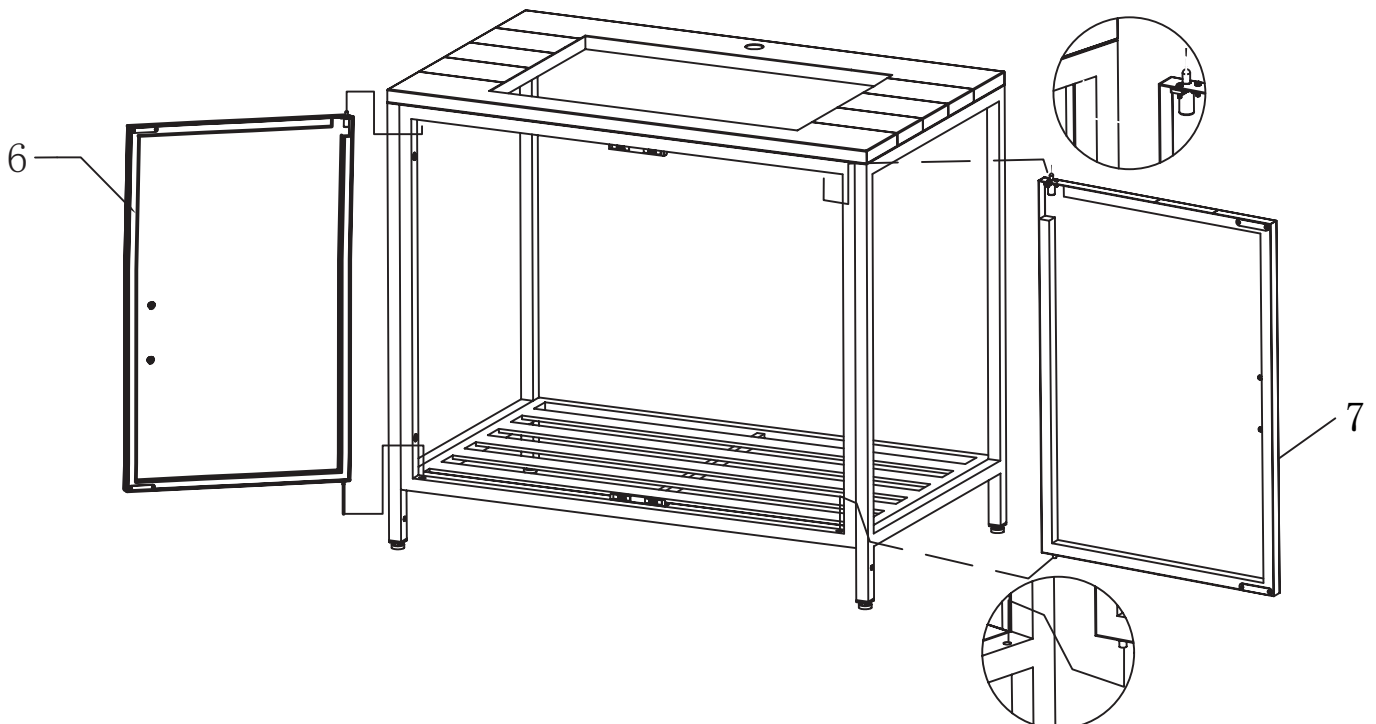

9

ASSEMBLY

9

Install the back wall (1) with 4 pcs A screws and 4 pcs F protection washers.

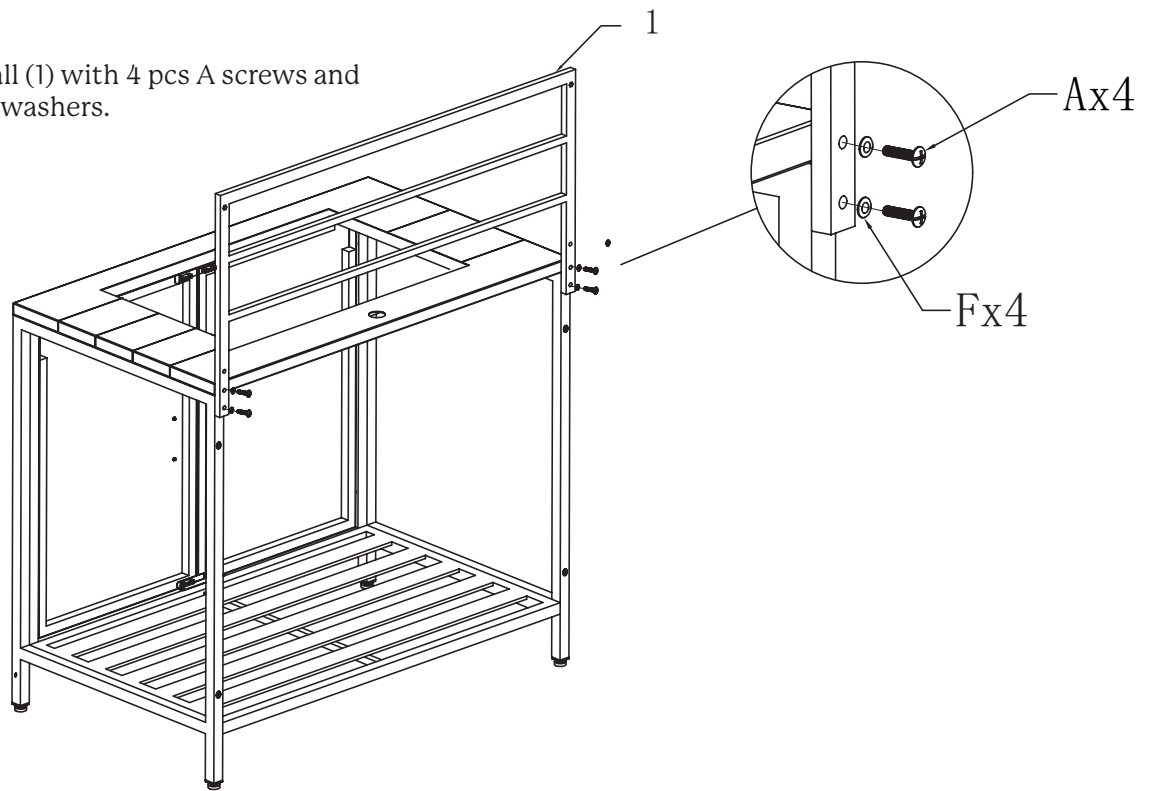

10

Lock the module to the wall when needed. You can also start this step after the sink (9) and faucet (10) are installed.

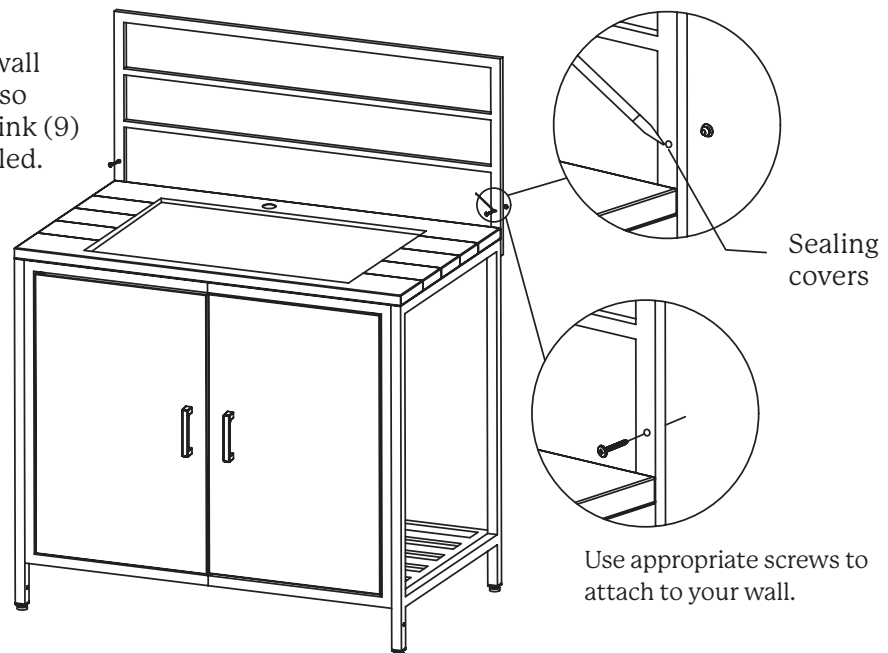

Use leg connection and back connection with other modules after full assembly.

ASSEMBLY

11

Put the sink (9) into the hole of the top plate, and install the drain pipes on step 13.

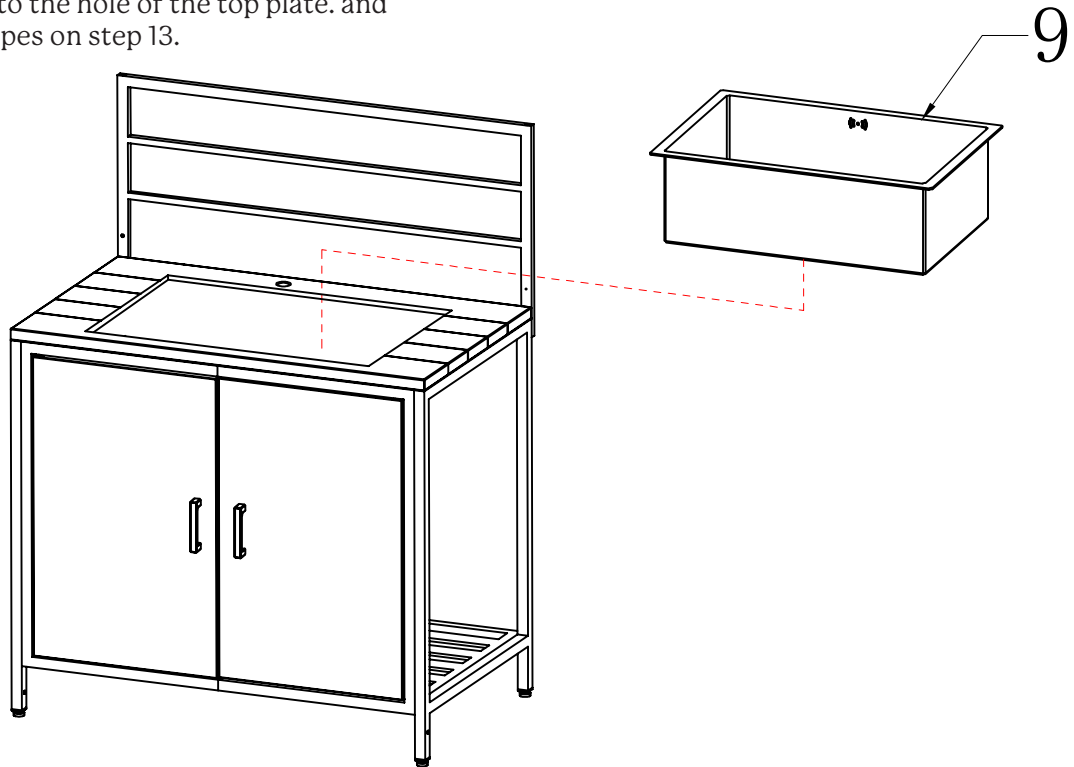

12

Install the faucet (10) with the included assembly instructions in the box of the faucet.

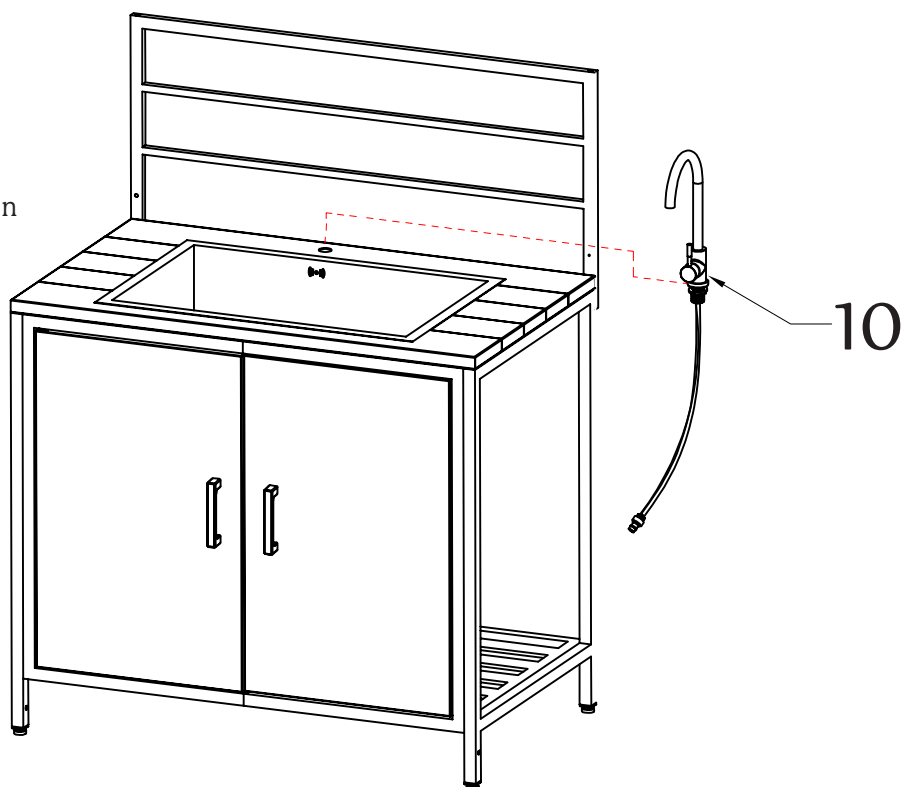

11

ASSEMBLY

13

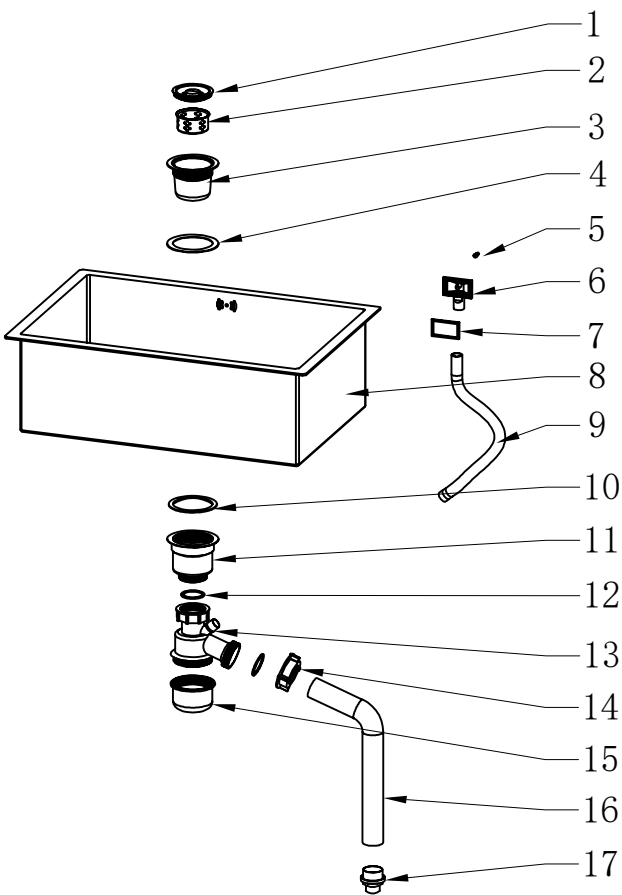

CODE	PART NAME	QTY
1	DRAIN CUP LID	1
2	FILTER	1
3	DRAIN CUP	1
4	UPPER SEALING RING	1
5	M5x12 SCREW	1
6	OVERFLOW HEAD	1
7	RECTANGLE SEALING RING	1
8	SINK	1
9	OVERFLOW PIPE	1
10	LOWER SEALING RING	1
11	DRAIN CUP SLEEVE	1
12	DRAIN PIPE SEALING RING	2
13	DRAIN PIPE CONNECTOR	1
14	DRAIN PIPE NUT	1
15	ANTI ODOR CUP	1
16	DRAIN PIPE	1
17	WATER OUTLET	1

ASSEMBLY

STEP 1

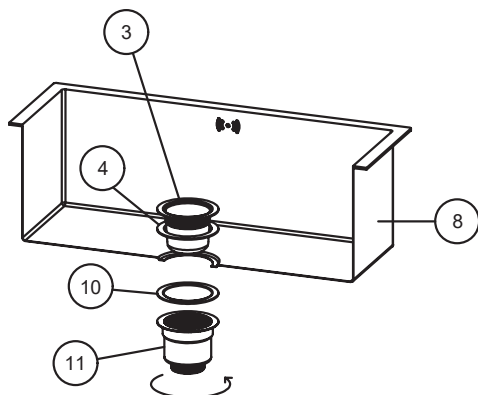

Put part 3,4 ,10 and 11 in sequence into the sink.

STEP 2

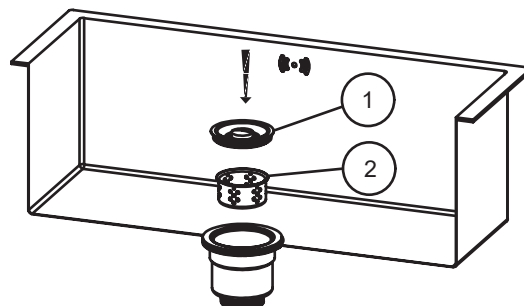

Put filter (2) and drain cup lid (1) onto drain cup (3).

STEP 3

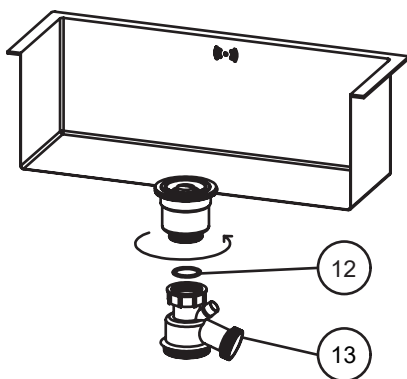

Put sealing ring (12) on part4, install part 13.

STEP 4

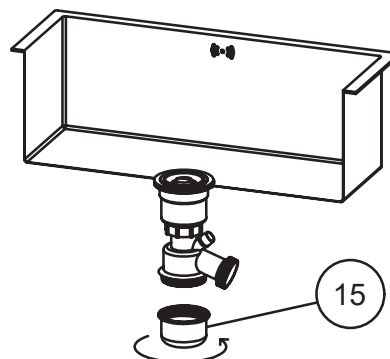

Install anti odor cup (15) onto grain cup connector (13).

STEP 5

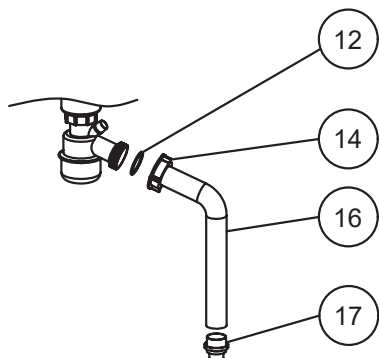

Install the drain pipe (16) to the drain pipe connector with sealing ring (12) and drain nut (14). Connect the water outlet (17) to drain pipe.

STEP 6

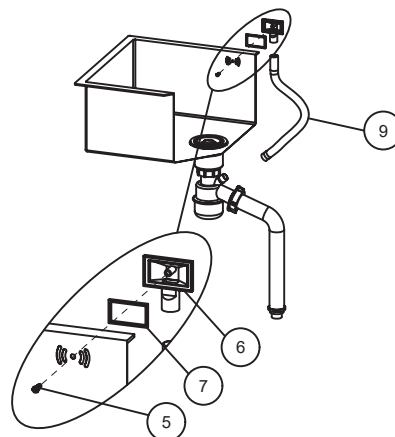

Connect the overflow pipe(9) to overflow head (5). Install overflow head to the sink with rectangle sealing ring (7) and M5x12 screw (5). Connect the other end of overflow (9) to part (13).

SECURING THE MODULES

14

Adjust the legs:

Turn the foot pad to left or right to adjust the leg height to desired level.

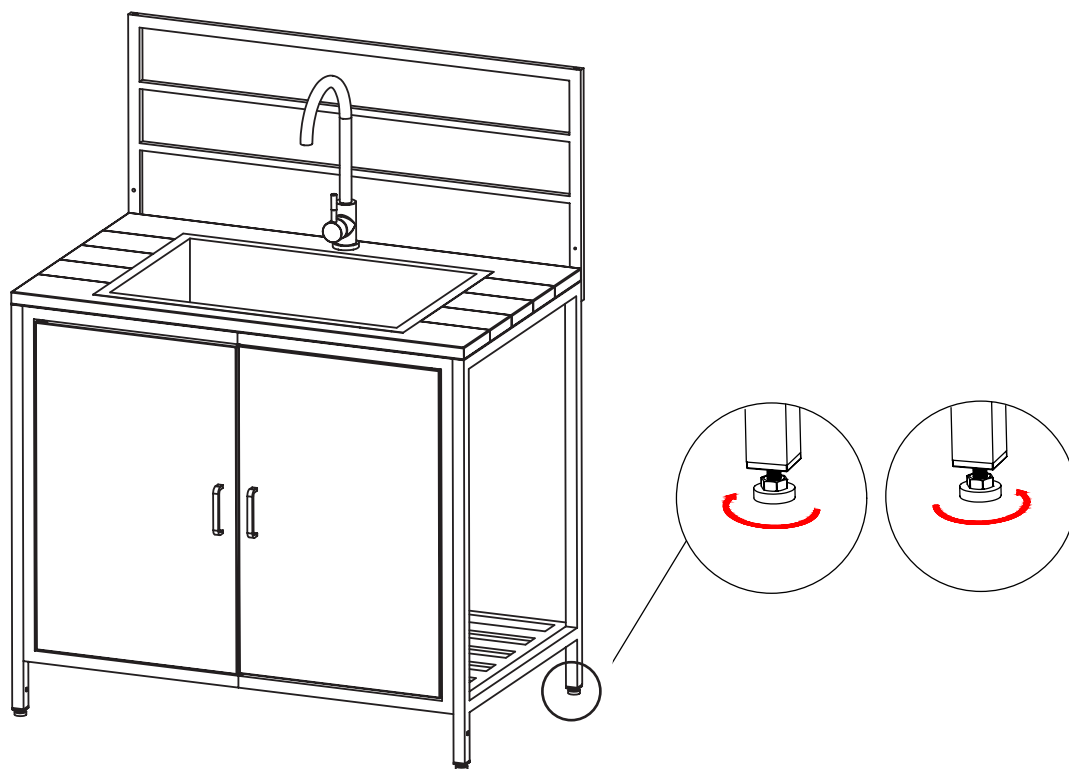

SECURING THE MODULES

15

Full sets combo.

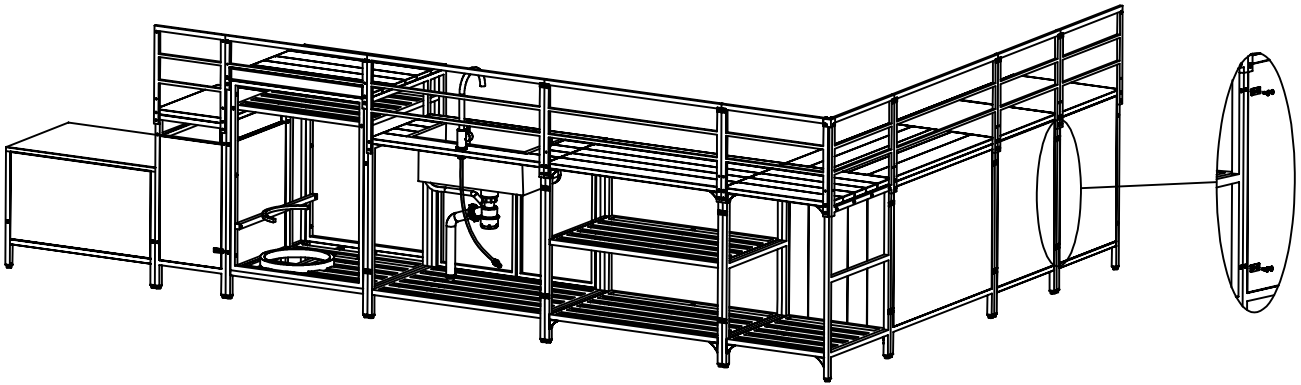

Disassemble the pre-installed screws on the modules, then use back connection and the screws provided to fit each module at the back.

16

Take out the pre-installed sealing covers on front and back of the back wall with a tool (not provided). Use appropriate screws to attach the modules to your wall.

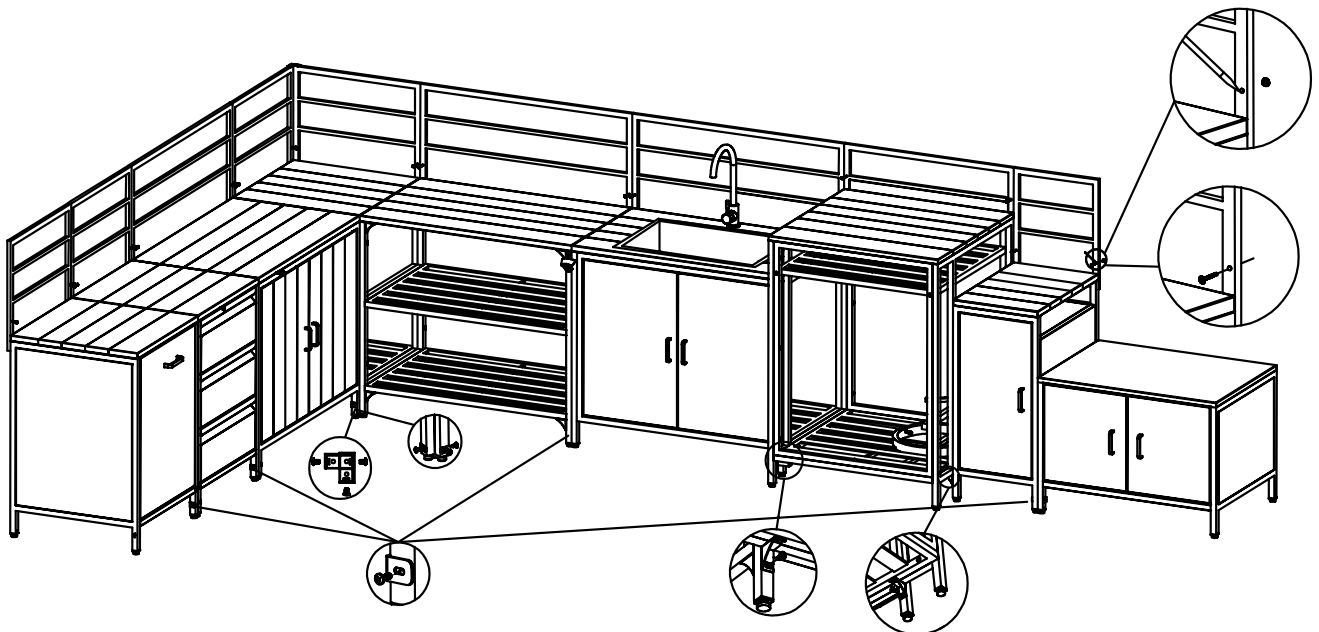

Disassemble the pre-installed screws on the legs, then use leg connection and the screws provided to fit each module at the front.

WARNING

THE MODULE SHOULD BE SECURED TO THE WALL. THE MODULE HAS HOLES FOR MOUNTING IN THE BACK PANEL. IF MULTIPLE MODULES ARE USED, THEY SHOULD BE FASTENED TO THE WALL AND CONNECTED TO EACH OTHER USING THE INCLUDED BRACKETS ON THE FRONT AND BACK SIDES OF THE MODULES. THIS IS TO PREVENT THE MODULE FROM TIPPING OVER IN STRONG WINDS.



- If the furniture is to be stored outdoors all year, then you must ensure that water is drained from the furniture and that it is not left standing with water in the frame. This can cause frost damage and will not be covered by warranty.
- All metals can rust under the right conditions. Aluminum has an extremely high resistance, but regular cleaning and maintenance will increase its lifespan.
- Salts, sea air, bird droppings, paint scratches, and other strain may harm the finish over time. Clean regularly to prevent this from occurring.
- Note! The furniture may have sharp edges. We have done our best to remove sharp edges during production, but we recommend to exercise caution when handling the product.
- THIS PRODUCT IS DESIGNED FOR USE IN DOMESTIC HOUSEHOLDS AND IS NOT INTENDED FOR COMMERCIAL USE IN RESTAURANTS OR SIMILAR VENUES
- The painted surface of the furniture may be affected by sunlight. This does not affect the properties of the furniture and is not covered by warranty. To prevent this, use a cover to protect.
- The painted surface of the furniture can be worn/scratched during use. This must be fixed to prevent rust from forming in damaged surface areas.
- The furniture must only be used for its intended purpose and must not be exposed to weight exceeding its maximum specification nor exposed to other loads/strain. DO NOT STAND OR JUMP ON THE FURNITURE AS THIS MAY DAMAGE THE PRODUCT.
- In the event the furniture is overloaded, the joints and fittings may be damaged, affecting the furniture's strength and structure. This is not covered by warranty.
- Check for the presence of any damage before assembly.
Please contact support@fccproducts.no for any inquiries.
- The surface of the furniture may become very hot in direct sunlight. Please be aware of this and avoid use in high temperatures, as this may cause injury.
- The furniture is intended for outdoor use.
- Do not use electrical tools to assemble the furniture. Tools with excessive force may damage the surface coating of screws, damage enamel/painted parts of the module, and loosen pre-fitted nuts.
- Inserting screws wrongly, torquing with excessive force, or using electrical tools may damage the threading. The aluminum frames can bend if you tighten the screws too hard. Damage as such will not be covered by the warranty.
- Keep children and others who require supervision at a safe distance away to prevent them from climbing on the furniture. This may entail a risk of injury. Children must be supervised by adults when using the furniture.
- Covers must not be applied before the furniture is completely cool and dry. Moisture on the inside of covers may cause large formations of surface rust and damage to painted components.

MAINTENANCE

MAINTENANCE OF ALUMINUM FURNITURE

Aluminum requires less maintenance, but it may corrode over time in damp and salty environments.

- Ensure regular cleaning with gentle soapy water and a soft brush or sponge. If the furniture is exposed to a lot of acid rain, pollution, bird droppings, and similar waste that can corrode the surface treatment and leave ugly stains. Clean the surface with clean water at the end to remove remaining soap.
- Please note that while aluminum can handle a lot, it can't take everything. It won't withstand being bent repeatedly, and corrosion may occur in the presence of salts, salt water, and other metal alloys. Aluminum is generally considered rust-free, but corrosion may occur if it is left exposed.
- If the furniture takes surface damage that removes the paint, we recommend using a paint repair pen or similar tool to prevent oxidization. Contact your nearest retailer.
- Use a garden hose for cleaning. The use of pressure washers is not recommended, as this may harm the furniture and its surface coating.

SHORT AND LONG-TERM STORAGE

- Clean the furniture before storing and make sure provide it with extra protection. Use suitable cleaning products and wipe it down with a damp cloth.
- Make sure that the furniture is dry and not heated before storing under a furniture cover. If this is skipped, it may create a reaction with the cover, or leave stains or undesirable marks on the furniture. If there is moisture on the furniture, it may cause frost damage to the frame or joints. This may expand and damage the structure if ice forms. Ensure that there is no water in the frame before storage. If present, any water must be drained using the drainage holes.
- If you are storing the furniture in a cover during the winter, ensure proper ventilation.
- The furniture must be stored right side up to prevent water from entering the frame.
- Please note that damage caused by improper storage and/or frost damage will not be covered by warranty.
- If the furniture is to be stored outdoors all year, then you must ensure that water is drained from the furniture and not left standing with water in the frame. This can cause frost damage and will not be covered by warranty.

WARRANTY CLAIM

This product is covered by a warranty in accordance with consumer legislation. It has undergone strict quality controls and testing at the factory. If there are any parts missing or the product has been damaged, please contact your dealer or the consumer contact below for help.

In the event of damage to the product, we ask for pictures of the damage and damage to the product's packaging is attached to the complaint.

Faults due to misuse, lack of maintenance or modification of the product will invalidate the warranty. Damaged parts not due to a fault with the product will be invoiced according to our price list + carriage and administration fee.

If new parts are needed or in the event of a warranty claim, please contact your dealer or consumer contact:

FCC PRODUCTS AS

KJELLER VEST 3, 2007 KJELLER,
NORWAY

☎ +47 924 78 600

✉ support@fccproducts.no

Our support department is staffed between
09:00 and 15:00 Monday to Friday.

Scan code to reach consumer contact:



Always attach your receipt and product serial number when making a warranty claim.

Produced in China for FCC Products.

We are always looking for ways we can improve our products. Therefore, we reserve the right to change technical specifications at any time. You will always find the latest manual on Fccproducts.no

FCC By the Flying
Culinary Circus

Fccproducts.no