

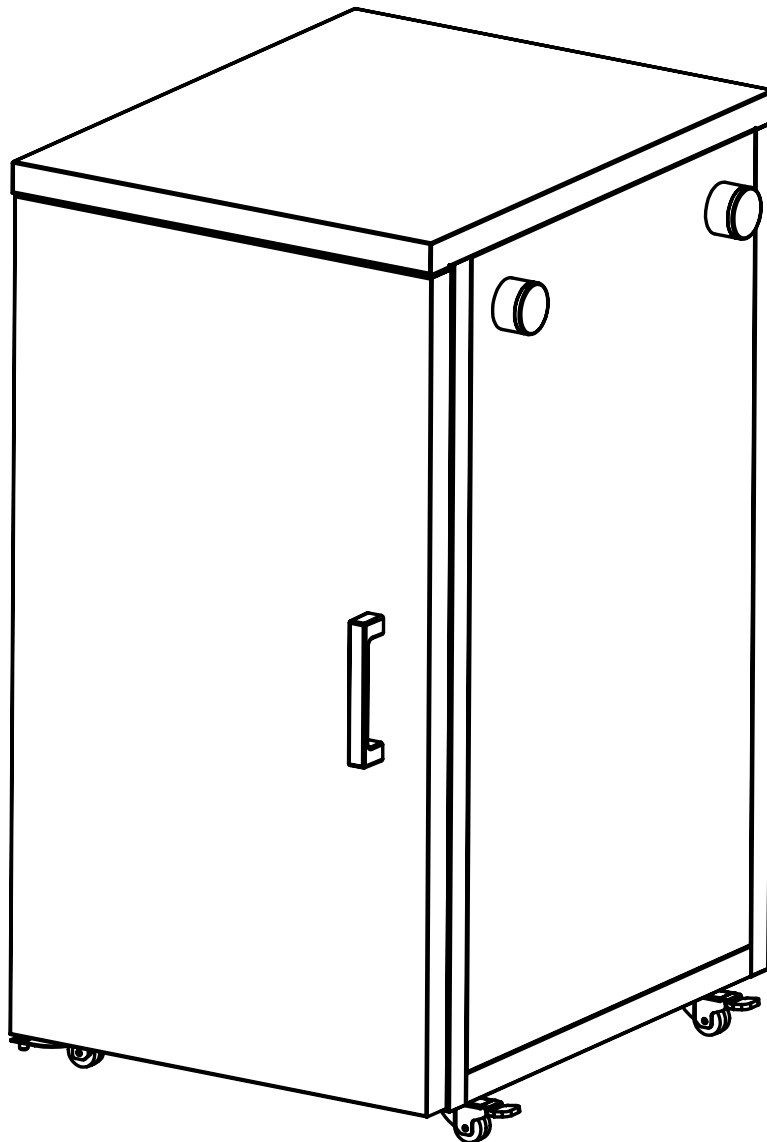

Side Cabinet Outdoor kitchen



FCC-A-10158

Assembly, maintenance and safety

RCC



The Flying Culinary Circus is the world's first traveling cooking group.

In 2005 Trond, Hans-Kristian, Mathias, and Tor went to New York.
A journey that ended up being an adventure of a lifetime.

With 65 countries and 300,000 hours of culinary experience in the Chef whites, we have developed, designed, and produced a wide range of grills and accessories that add something new and unique to the grill range in Scandinavia.

Each product is a testament to our commitment to high quality, functionality, and affordability.

We want to inspire the world through cooking with our vision:
"Share the Fun of Cooking!"

PARTS LIST

CODE	DESCRIPTION	QTY
1	BOTTOM PANEL	1
2	SIDE PANEL	2
3	DOOR FRAME	1
4	BACK PANEL	1
5	TABLE TOP	1
6	SWIVEL CASTER	4
7	SHELF	1
8	DOOR	1
9	BACK SEALING PANEL	1
10	MAGNET	2
11	SPACER	2
12	DOOR PIN HOLDER	1
13	DOOR HANDLE	1

CODE	DESCRIPTION	QTY
A	M6X15 SCREW	21
B	M4X12 SCREW	24
C	M4X25 SCREW	2
D	M4X4 SCREW	2
E	M3X12 SCREW	2
F	M6 NUT	1
G	UPPER DOR PIN	1
H	LOWER DOOR PIN	1
O	SPANNER	2

We recommend assembling the module on a flat surface.

Maximum load: 60 kg

Net weight: 12.2 kg

Maximum load table top: 30 kg

Maximum load middle shelf: 15 kg

Maximum load bottom shelf: 25 kg

Insert all screws first, do not tighten. Tighten all screws when module is fully assembled.

WARNING!

DO NOT USE ELECTRICAL TOOLS WHEN INSTALLING. TOOLS WITH MACHINE POWER CAN DAMAGE THE COATED SURFACE AND SCREWS WHICH CAN LEAD TO PRODUCT DAMAGE AND RISK OF RUST.



TIPS! If the furniture appears crooked or bowed after fully assembled, loosen all the screws. Straighten each part and tighten screws again. The furniture should be placed and mounted on a level surface for the best possible result, but to take up any unevenness you can adjust the height of each leg individually.

EXPLODED DRAWING

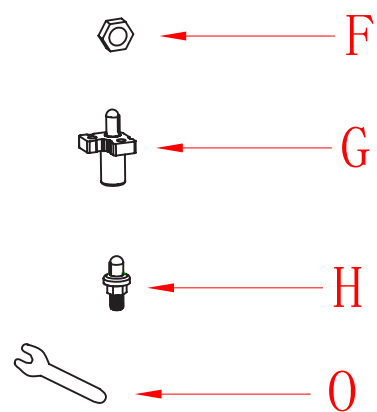
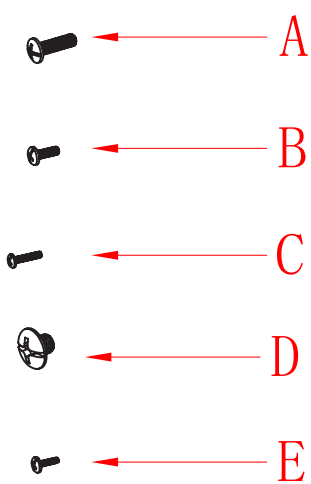
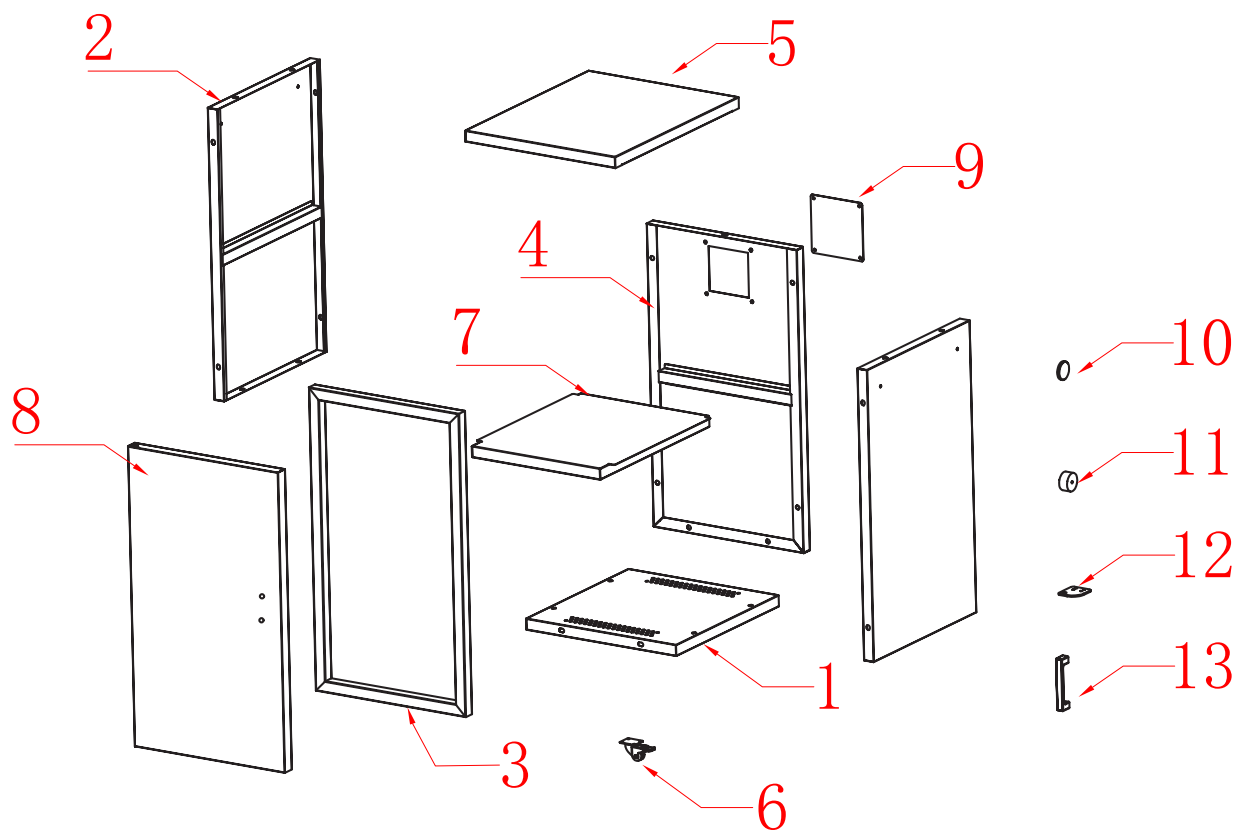

ASSEMBLY

1

Attach the side panels (part 2) on bottom panel (part 1) with 4 pcs A screws.

PLACE A PIECE OF CARDBOARD ON THE FLOOR (E.G THE OUTER CARTON) TO PREVENT SCRATCHING THE UNIT AND PARTS DURING ASSEMBLY.

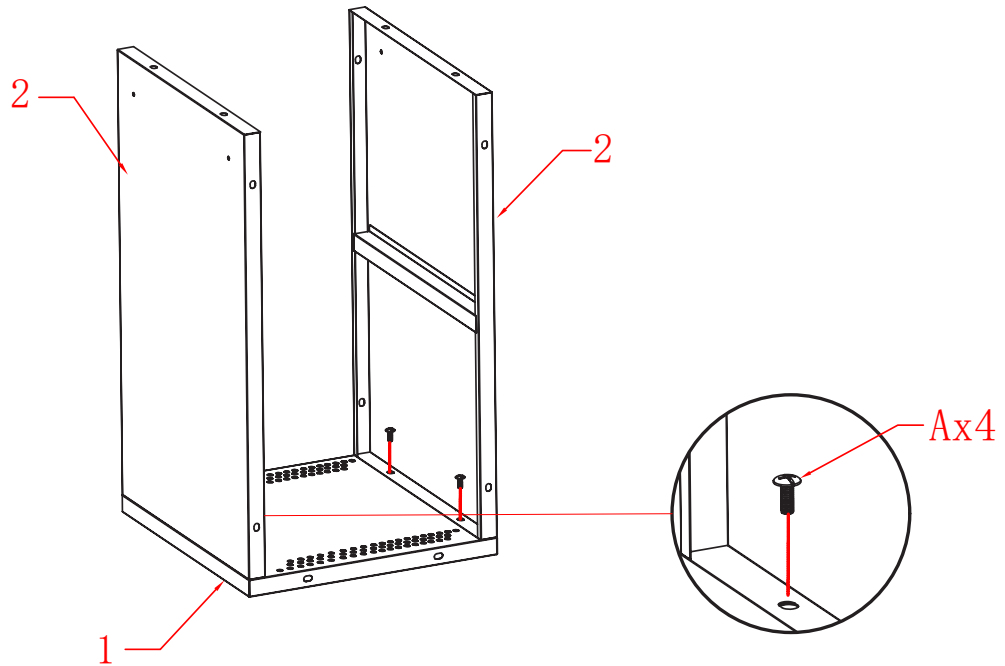

2

Attach the door frame (part 3) on the side panels with 4 pcs A screw.
Tip: Please be noted the side with 8 holes downward. (Necessary for step 9 and 11)

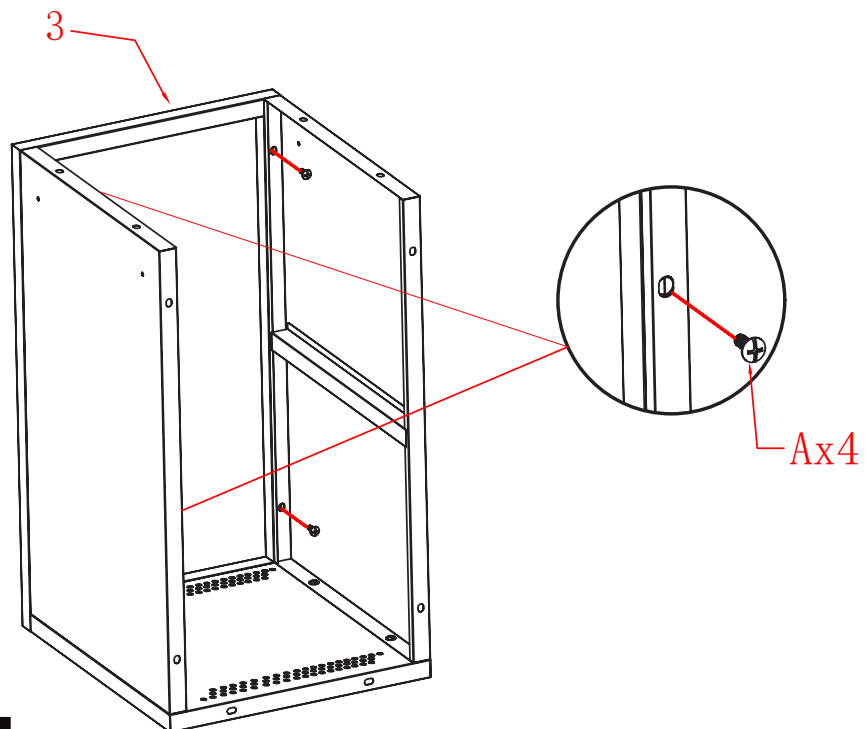

ASSEMBLY

3

Attach the back panel (part 4) to side panels with 4 pcs A screws.

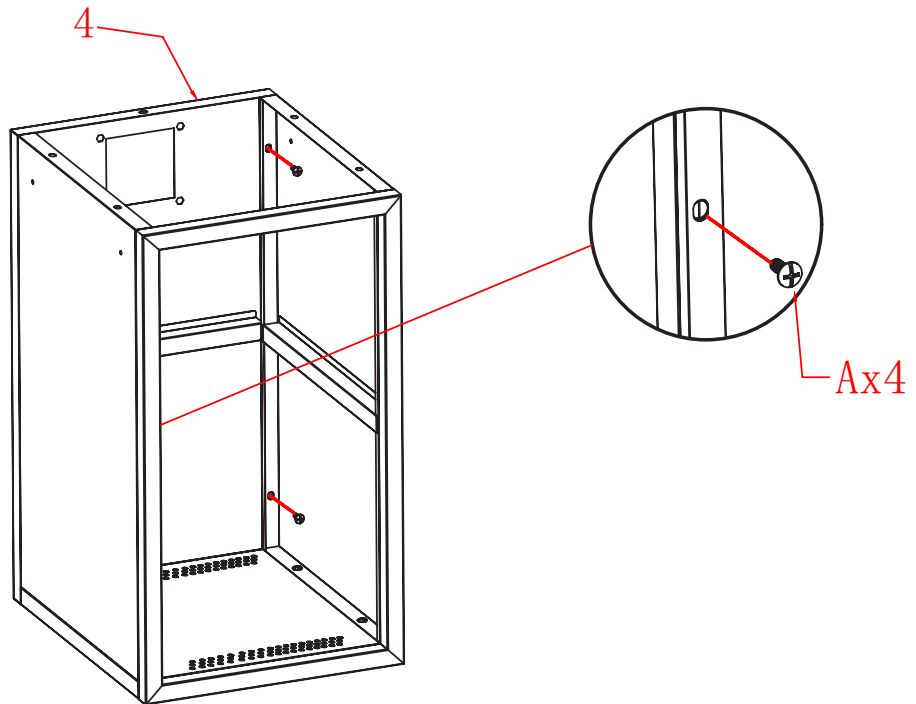

4

Turn over the assembly. Attach the table top (part 5) to the assembly with 5 pcs A screws. Lock the door frame and back panel to bottom panel with 4 pcs A screws.

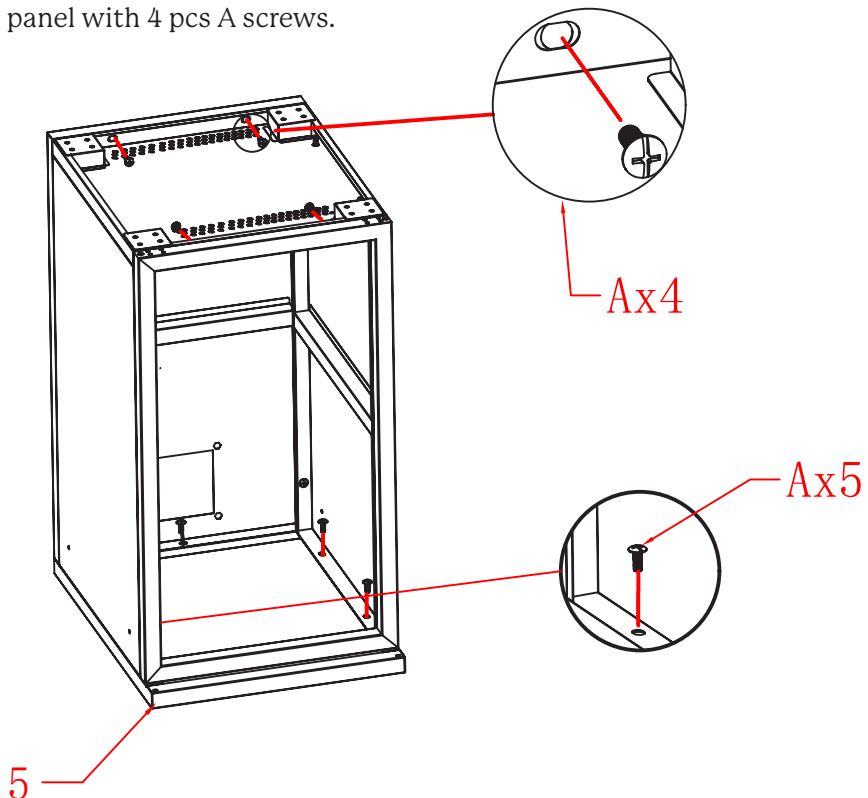

ASSEMBLY

5

Attach the door pin holder (part 12) with 4 pcs B screws.

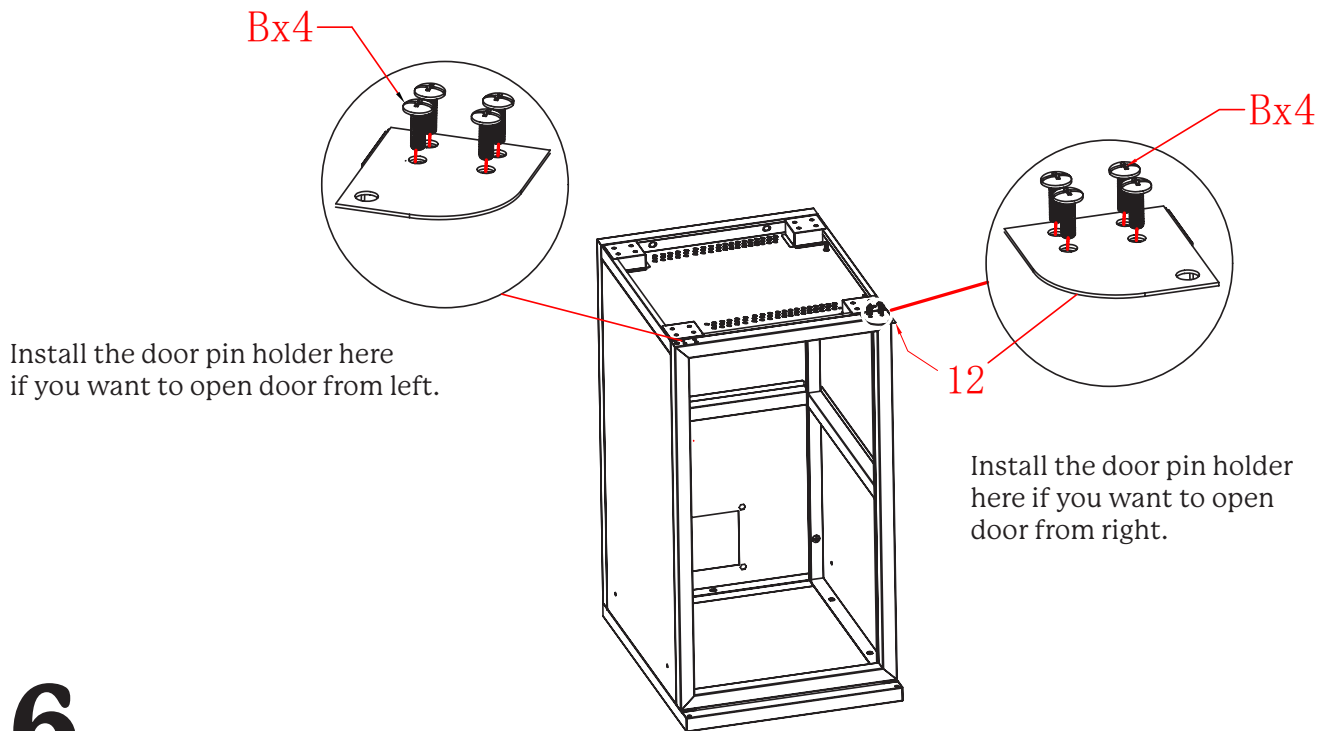

6

Attach the swivel casters (6) with 16 pcs B screws.

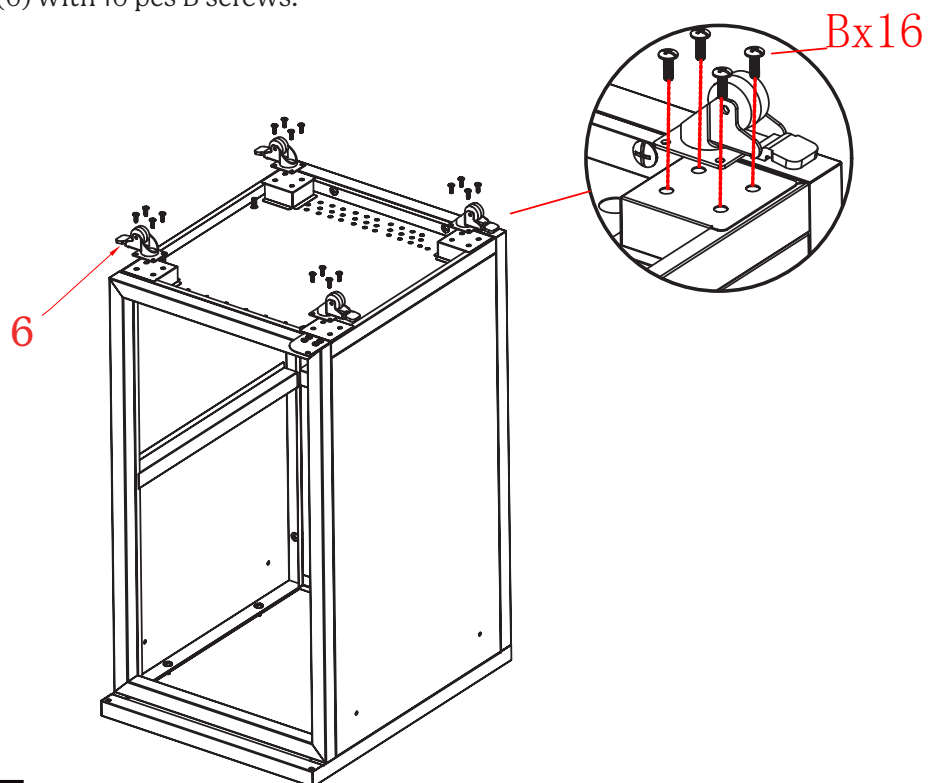

ASSEMBLY

7

Turn over the assembly and slide the shelf into the cabinet.

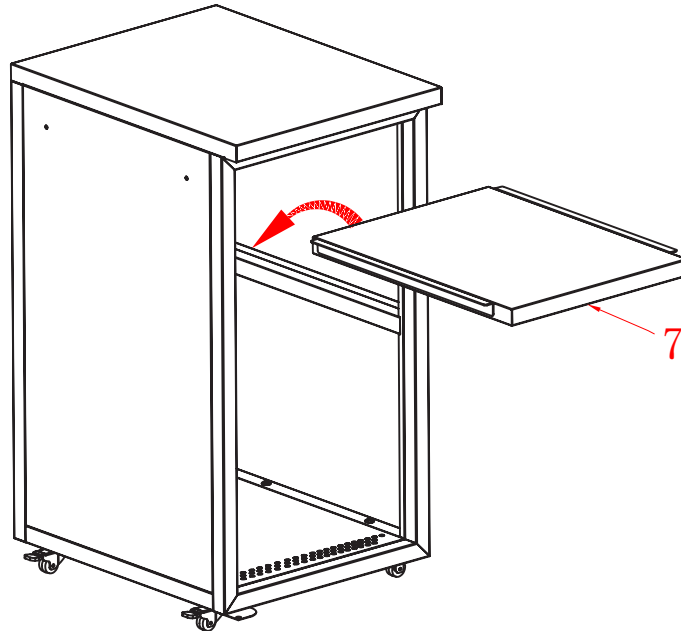

8

Attach door handle (Part 13) to the door (Part 8).

Install the upper door pin (G) here with 2 pcs E screws if you want to open the door from left.

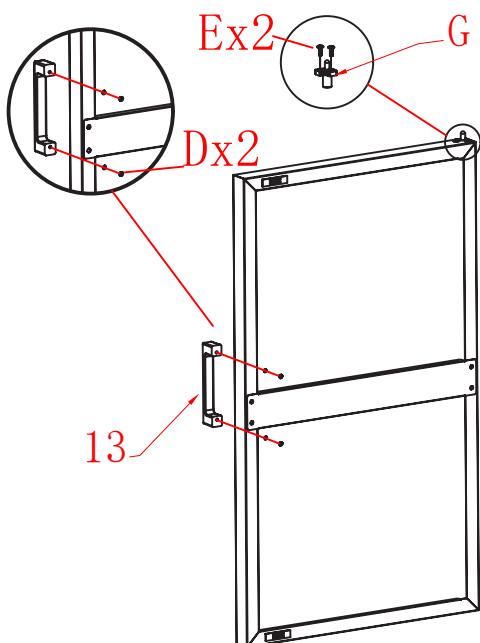

Install the upper door pin (G) here with 2 pcs E screws if you want to open the door from right.

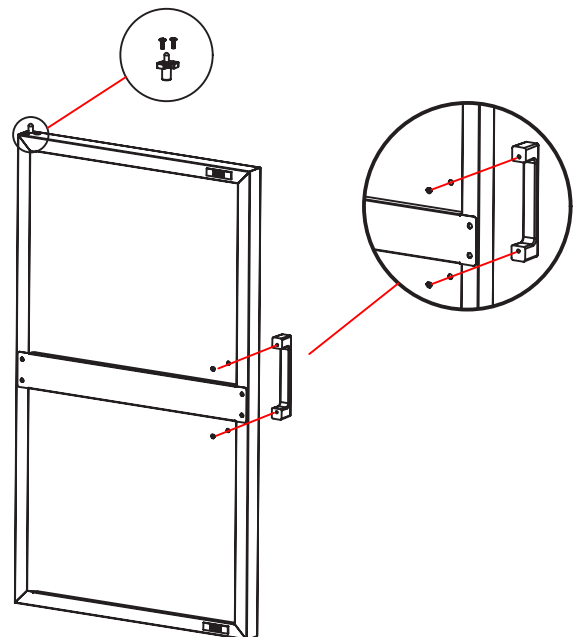

ASSEMBLY

9

Install the lower door pin (H) onto the door pin holder with nut (F), secure them with spanner.

Just a reminder, the door pin holder can be installed either on left or right depending on your need.

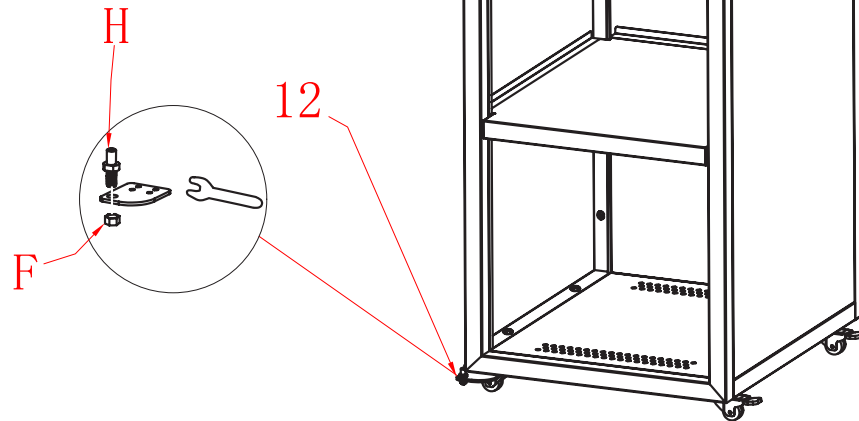

10

1) Insert the door pin into the hole of the bottom of door frame.

2) Press the upper pin and push the door into the frame, then release the upper pin and let it insert into the hole of the upper of door frame.

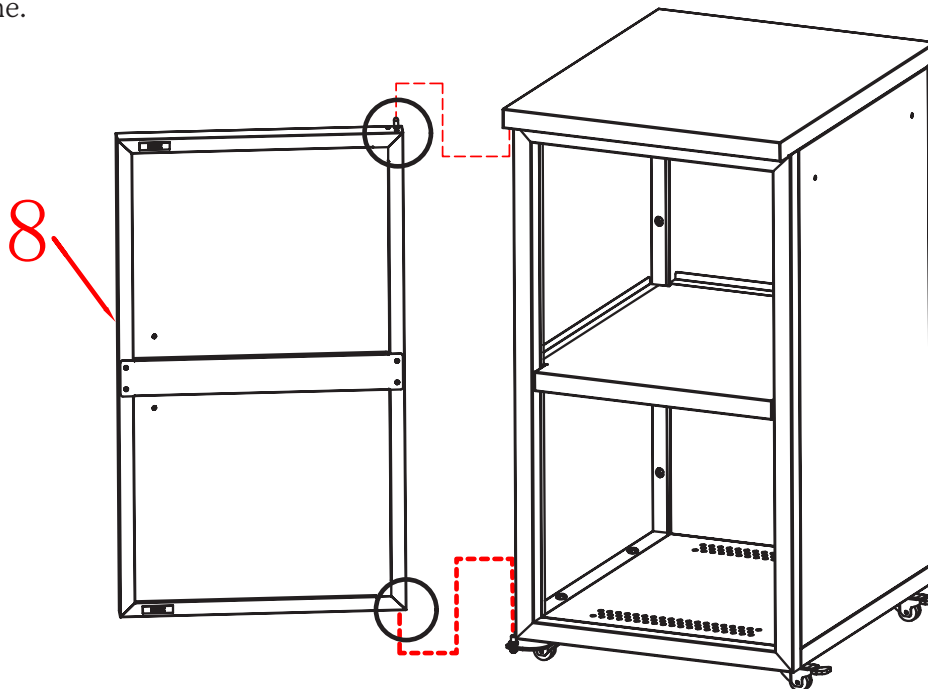

ASSEMBLY

11

Open the door from left.

- 1) Insert the door pin into the hole of the bottom of door frame.
- 2) Press the upper pin and push the door into the frame, then release the upper pin and let it insert into the hole of the upper of door frame.

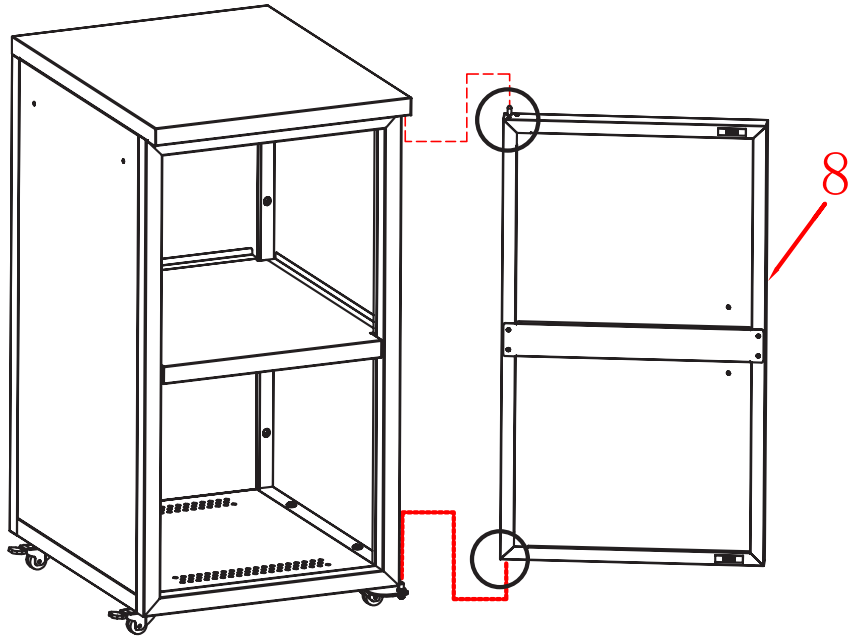

12

Attach the back sealing panel (Part 9) to the back panel with 4 pcs B screws.
(Optional to install and should not be installed if one intends to store a gas bottle in the cabinet).

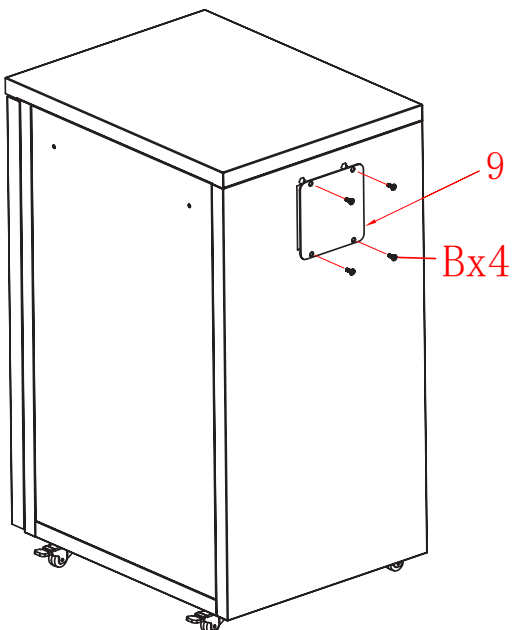

13

Attach the spacer (part 11) and magnet (part 10) with 2 pcs C screws.
The magnet can be mounted with or without spacers, or completely without the magnet if you do not want these.

Part 10 and Part 11 can be installed either on the left or right side, depending on your preference (Optional to install).

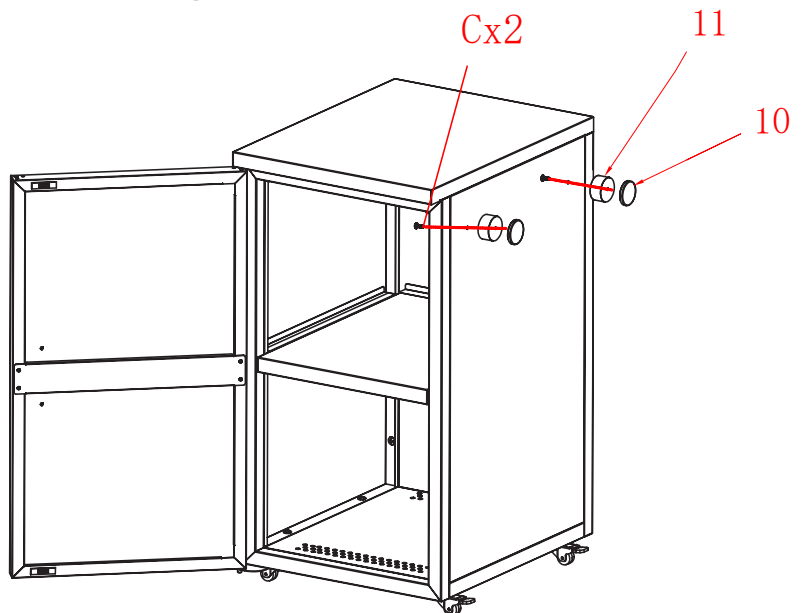

11

WARNING

- If the furniture is to be stored outdoors all year, then you must ensure that water is drained from the furniture and that it is not left standing with water in the frame. This can cause frost damage and will not be covered by warranty.
- THIS PRODUCT IS DESIGNED FOR USE IN DOMESTIC HOUSEHOLDS AND IS NOT INTENDED FOR COMMERCIAL USE IN RESTAURANTS OR SIMILAR VENUES
- Covers must not be applied before the furniture is completely cool and dry. Moisture on the inside of covers may cause large formations of surface rust and damage to those parts that are in coated steel and stainless steel.
- VARNISHED PARTS WILL BE ABLE TO BLEACH UNDER THE INFLUENCE OF SUNLIGHT.
- Keep children and others who require supervision at a safe distance away to prevent them from climbing on the furniture. This may entail a risk of injury. Children must be supervised by adults when using the furniture.
- Inserting screws wrongly, torquing with excessive force, or using electrical tools may damage the threading. Damage as such will not be covered by the warranty.
- Do not use electrical tools to assemble the furniture. Tools with excessive force may damage the surface coating of screws, damage enamel/painted parts of the module, and loosen pre-fitted nuts.
- The surface of the furniture may become very hot in direct sunlight. Please be aware of this and avoid use in high temperatures, as this may cause injury.
- Check for the presence of any damage before assembly.
Please contact support@fccproducts.no for any inquiries.
- The painted surface of the furniture can be worn/scratched during use. This must be fixed to prevent rust from forming in damaged surface areas.
- The painted surface of the furniture may be affected by sunlight. This does not affect the properties of the furniture and is not covered by warranty. To prevent this, use a cover to protect.
- Note! The furniture may have sharp edges. We have done our best to remove sharp edges during production, but we recommend to exercise caution when handling the product.

WHEN YOU ARE DONE GRILLING, THE GAS BOTTLE SHOULD ALWAYS BE TURNED OFF AT THE SWITCH ON THE REGULATOR.



MAINTENANCE

COATED AND STAINLESS STEEL PARTS

Inadequate maintenance/cleaning may cause coated or stainless steel parts of the furniture to begin rusting. To maintain the great appearance and surface of the furniture, it must be regularly cleaned using gentle cleaning agents and warm water to remove salt, grease and other residue that can harm the surface. After washing, dry the surface off with a soft cloth.

Coated surfaces must be treated with a polishing agent (e.g., car polish) and stainless steel parts must be treated with a thin layer of acid-free oil one to two times per year. If the product is kept in coastal areas, we recommend performing treatment more often to prevent salt carried by wind/rain from causing the surface of the metal to rust.

Surface rust can be removed by cleaning the surface and applying a polishing agent. Please note that the warranty only covers rust perforation.

SHORT AND LONG-TERM STORAGE

- Clean the furniture before storing and make sure provide it with extra protection. Use suitable cleaning products and wipe it down with a damp cloth.
- Make sure that the furniture is dry and not heated before storing under a furniture cover. If this is skipped, it may create a reaction with the cover, or leave stains or undesirable marks on the furniture. If there is moisture on the furniture, it may cause frost damage to the frame or joints. This may expand and damage the structure if ice forms. Ensure that there is no water in the frame before storage. If present, any water must be drained using the drainage holes.
- If you are storing the furniture in a cover during the winter, ensure proper ventilation.
- The furniture must be stored right side up to prevent water from entering the frame.
- Please note that damage caused by improper storage and/or frost damage will not be covered by warranty.
- If the furniture is to be stored outdoors all year, then you must ensure that water is drained from the furniture and not left standing with water in the frame. This can cause frost damage and will not be covered by warranty.

WARRANTY CLAIM

This product is covered by a warranty in accordance with consumer legislation. It has undergone strict quality controls and testing at the factory. If there are any parts missing or the product has been damaged, please contact your dealer or the consumer contact below for help.

In the event of damage to the product, we ask for pictures of the damage and damage to the product's packaging is attached to the complaint.

Faults due to misuse, lack of maintenance or modification of the product will invalidate the warranty. Damaged parts not due to a fault with the product will be invoiced according to our price list + carriage and administration fee.

If new parts are needed or in the event of a warranty claim, please contact your dealer or consumer contact:

FCC PRODUCTS AS

KJELLER VEST 3, 2007 KJELLER,
NORWAY

+47 924 78 600

✉ support@fccproducts.no

Our support department is staffed between
09:00 and 15:00 Monday to Friday.

Scan code to reach consumer contact:



Always attach your receipt and product serial number when making a warranty claim.

Produced in China for FCC Products.

We are always looking for ways we can improve our products. Therefore, we reserve the right to change technical specifications at any time. You will always find the latest manual on Fccproducts.no



By the Flying
Culinary Circus

Fccproducts.no